



The KETT Tool Co.

5055 Madison Road
Cincinnati, Ohio 45227
Phone 513-271-0833
Fax 513-271-5318

Component Parts of Power Units

253-29 (0 - 1200 RPM) USED ON KS-21AM & KS-22AM SAWS; E-141 SHEARS

253-32 (0 - 2200 RPM) USED ON KSV-32AM SAW & E-140 SHEAR

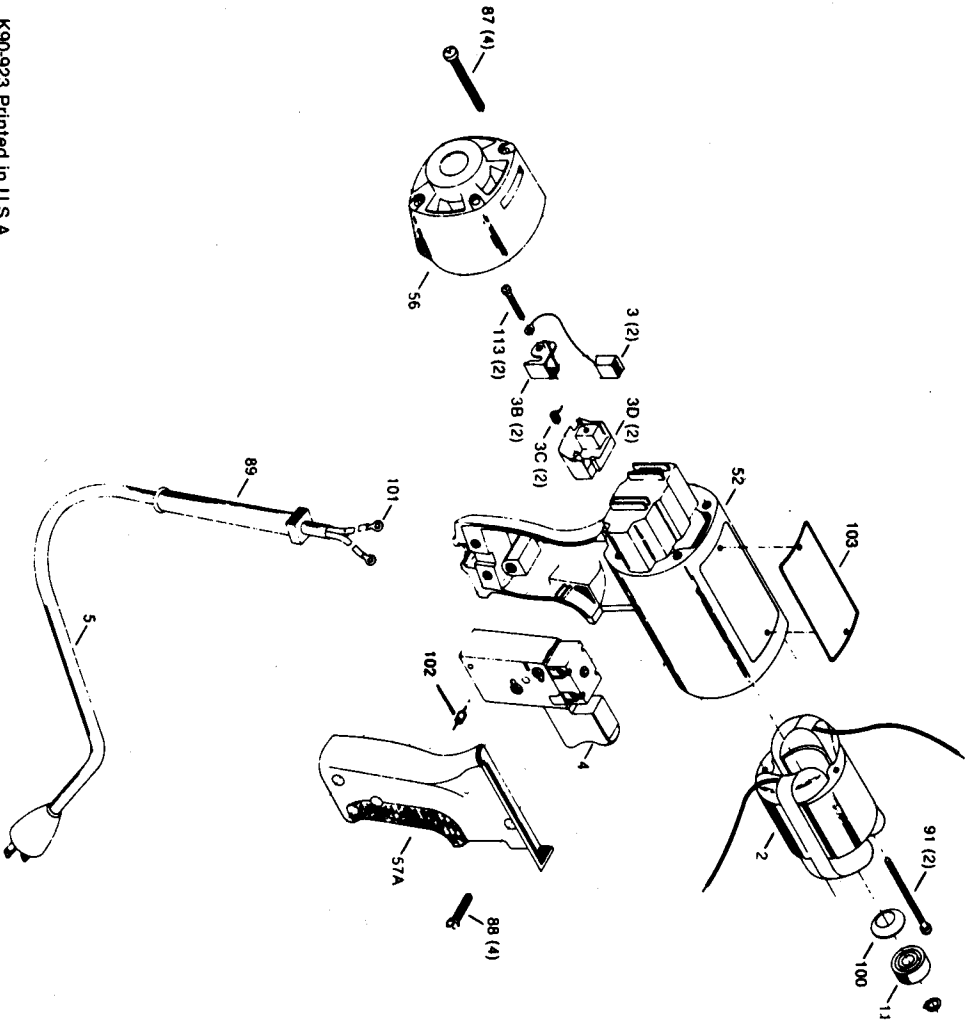

WHEN ORDERING PARTS BE SURE TO SPECIFY SERIAL NUMBER

* Part numbers apply only to Type motors with serial numbers up to 8499.
+ Part numbers apply only to Type 2 motors with serial numbers 8500 and higher.

** (Ref. No. 16)
Use 154-47 Spacer on all Shears.
Use 154-54 Spacer on all Saws.

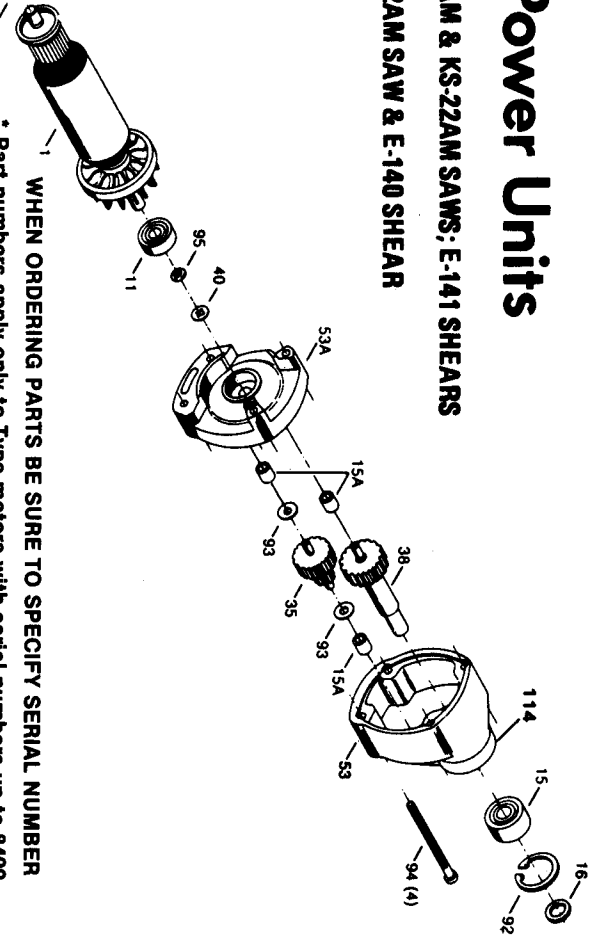

Ref. No.	Part No.	Description	Ref. No.	Part No.	Description
1	*861254K +691125	Armature Kit	53	866111	Gear Housing Assy., Incl. Ref. 15A
2	*861106K +691124	Field Kit	53A	858815	Incl. Plate Assy., Incl. Ref. 15A (2)
3	*858835 +690741	Brush	56	863263	Rear Cap
3B	*858520 +690742	Brush Holder	57A	*863264 +690903	Handle Cover
3C	*859845 *863400	Brush Spring	87	860902	Rear Cap Screw
3D	*691127 *860901	Brush Holder Assy. Switch	88	859384	Handle Screw
4	+690734 858761	Switch	89	810882	Strain Reliever
5	855284	Cord Set	90	802203	Retaining Ring
11	855220	Bearing	91	*861811 +691051	Field Screw
15	803873	Spindle Bearing	92	859769	Retaining Ring
15A	154-***	Bearing	93	858947	Flat Washer
16	855331	Spacer	93A	858420	Thrust Washer
35	855325	Inter. Gear (253-29)	94	861809	"O" Ring
38	855321	Spindle & Gear (253-32)	95	2334X	Gear Housing Screw
		Spindle & Gear (253-29)	100	842610	"O" Ring
		Motor Housing Kit (253-32)	101	*860190	Washer-Loading Terminal Plug
		Motor Housing Kit	102	+844694	
40	855336 *863265K +691126	Motor Housing Kit	103		Spec. Plate By Request
52			113	*858836 +854805	Brush Holder Screw Adapter 1 1/2" O.D. 1-3/8 - 20 LH Thread I.D.