



THE KETT TOOL COMPANY 5055 Madison Rd. - Cincinnati, Ohio 45227

Phone 513-271-0333 Fax 513-271-5318 www.kett-tool.com

COMPONENT PARTS OF 3/8" CAPACITY AC/DC POWER UNIT

MODEL NO. 253-10 SERIAL NOS. 3100 AND HIGHER

If tool bears serial number lower than 3100 then it is a Model 253-6. Request service bulletin No. K70-427 which covers replacement parts for this earlier model.

REPLACING THE 170-25 COUPLER: the coupler (170-25) is considered expendable. This part is actually a safety valve or a shear pin designed to break under severe strain or sudden impact so as to prevent serious damage to the more costly hardened and ground shafts, gears and bearings within the tool.

To replace a broken coupler first remove the 267-45 sleeve from the motor. This sleeve has a left hand thread so it must be turned in a *clockwise* direction. Fit a box wrench over the coupler. Extend the wrench horizontally and give it a sharp rap with a hammer using the inertia of the gear train as resistance to break the hold of the coupler on the spindle. Several raps may be necessary to break it loose.

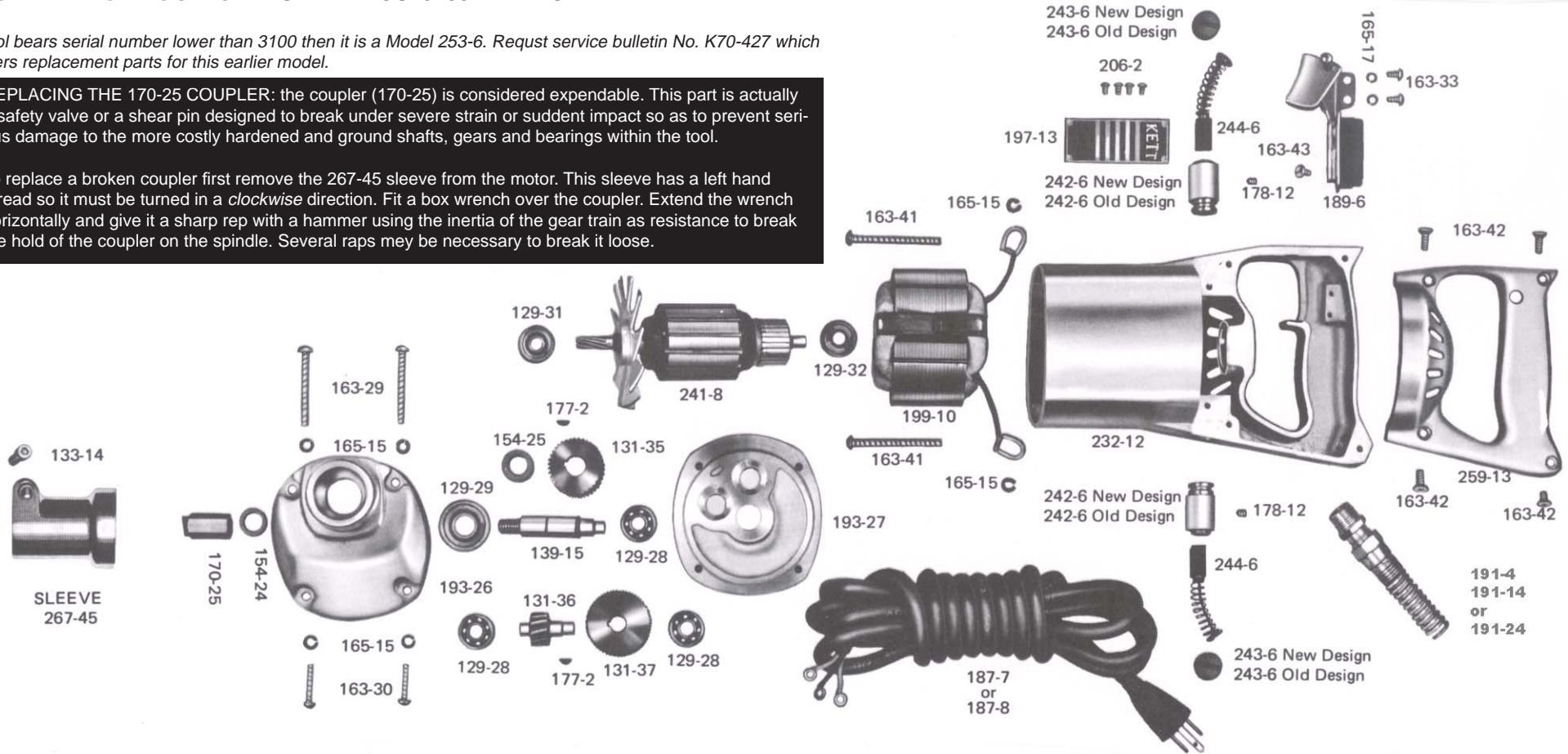

Part #	Description	Part #	Description	Part #	Description	Part #	Description
129-28	Ball Bearing	163-33	Switch Screw	191-14	Strain Reliever (1/4" Thread)	242-6	Brush Holder - New Design With Plastic Internal Thread
129-29	Front Spindle Bearing	163-41	Field Assembly Screw	191-24	Plastic Strain Reliever (3/8" Thread)		Old Design With Brass External Thread
129-31	Front Armature Bearing	163-42	Switch Cover Screw		Serial number 31372 and later	243-6	Brush Cap - New Design Plug Shape With External Thread
129-32	Rear Armature Bearing	163-43	Binding Head Screw	193-26	Gear Case		Old Design - Cup Shape With Internal Thread
131-35	Spindle Gear	165-15	Split Lock Washer	197-13	Name Plate	244-6	Brush and Spring Assembly
131-36	Intermediate Pinion	165-17	Lock Washer	199-8	Field - 230 Volts	259-13	Switch Cover
131-37	Intermediate Gear	170-25	Coupler	199-10	Field - 115 Volts	267-45	Connecting Sleeve
133-14	Clamping Screw	177-2	Pinion Key	206-2	Drive Screw		
139-15	Spindle	178-12	Brush Holder Screw	232-12	Motor Case		
154-24	Spacer	187-7	Electric Cord (.042 Dia.) & Plug	241-8	Armature - 115 Volts		
154-25	Gear Spacer	187-8	Electric Cord (.328 Dia.) & Plug	241-9	Armature - 230 Volts		
163-29	Gear Case Screw	189-6	Switch				
163-30	Gear Case Screw	191-4	Strain Reliever (3/8" Thread)				



KS-23 SAW UNIT

FOR TOOLS MADE AFTER JUNE, 2013 WITH NEW STYLE DEPTH STOP

PARTS LIST

* Use 267-45 Sleeve on KS-23AM
 * Use 567-2A Sleeve on KS-423 Saw

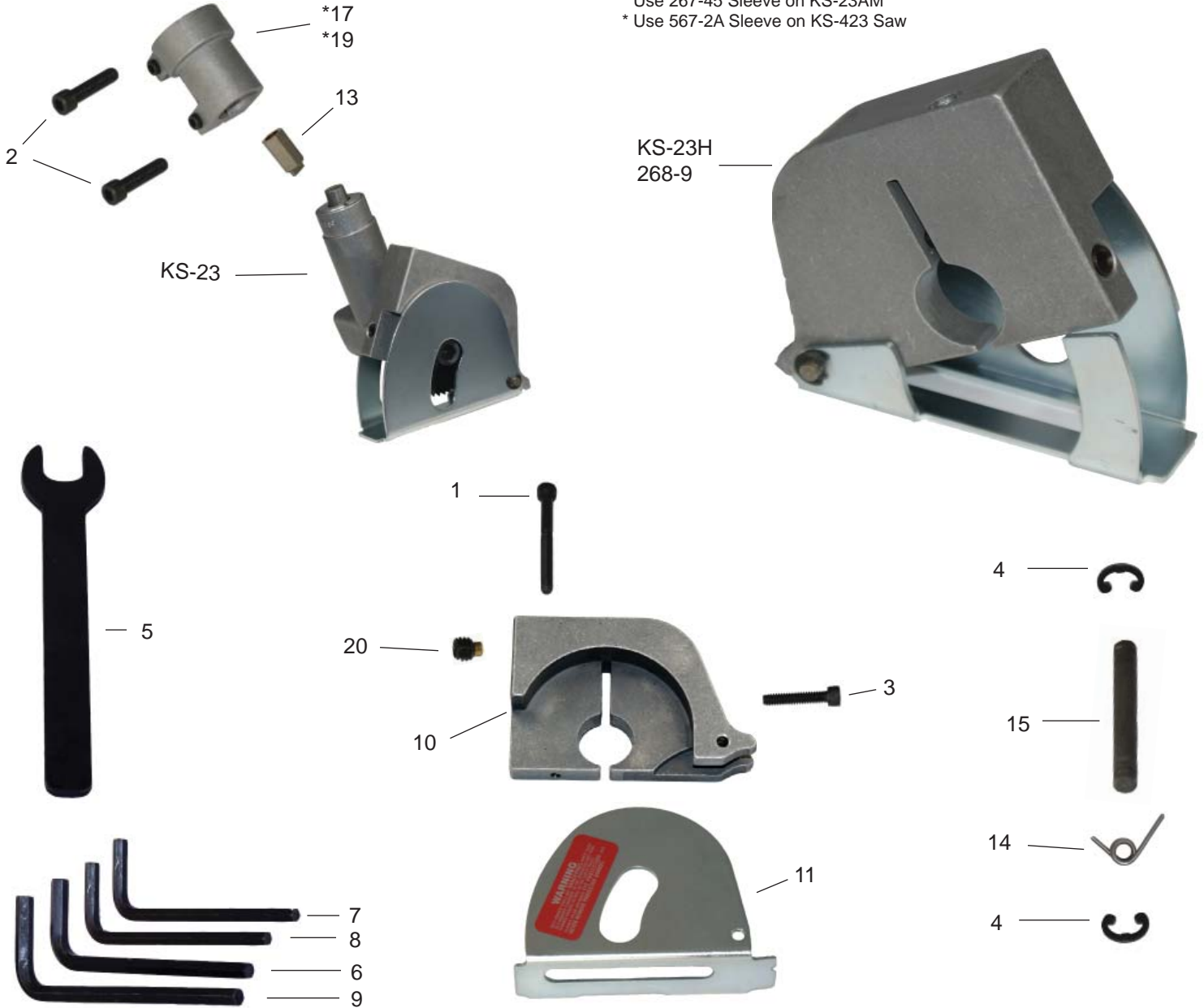

ITEM NO.	PART NO.	DESCRIPTION	REQ'D TOOL	ITEM NO.	PART NO.	DESCRIPTION	REQ'D TOOL
1	133-13	Clamping Screw	1	11	160-9	Saw Guard	1
2	133-14	Clamping Screw for 267-45	1	13	170-25	Coupler	1
	M133-37	Clamping Screw for 567-2A	1	14	191-12	Coil Spring	1
3	133-29	Screw	1	15	210-1	Guard Pin	1
4	141-10	Retaining Ring	2	*17	267-45	Connecting Sleeve	1
5	149-6	Spindle Wrench	1	18	268-9	KS-23 Saw Body	
6	150-1	3/16" Socket Key	1			& Guard Assembly	1
7	150-2	1/8" Socket Key	1	*19	567-2A	Connecting Sleeve	1
8	150-4	5/32" Socket Key	1	20	N5027	Set Screw	1
9	150-5	5/18" Socket Key	1				
10	156-9	Saw Body	1				

COMPONENT PARTS FOR KRA-5 GEARED ANGLE HEAD

s/n 15241 & higher

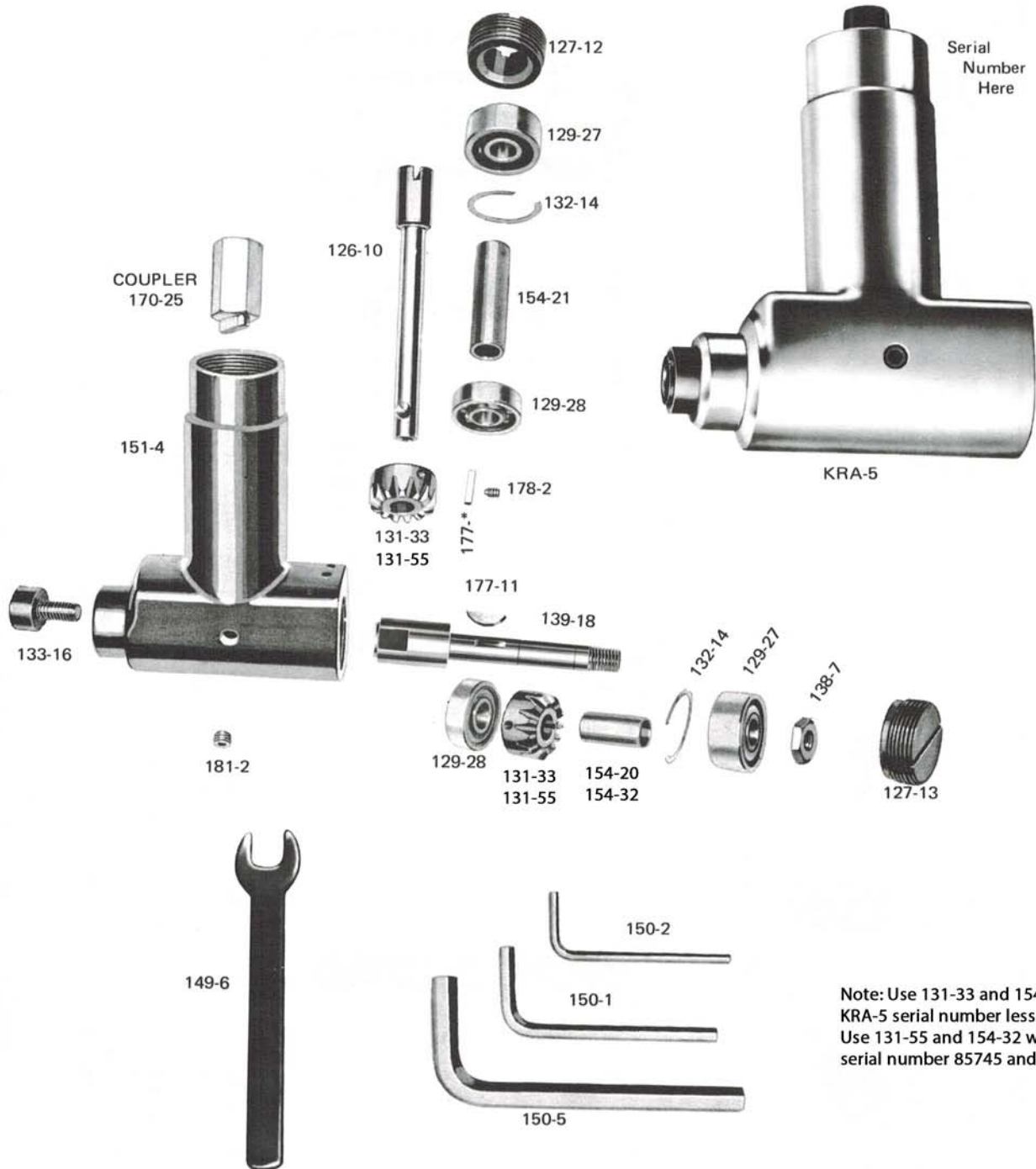

Note: Use 131-33 and 154-20 with KRA-5 serial number less than 85744
Use 131-55 and 154-32 with KRA-5 serial number 85745 and greater.

Part No.	Description	Part No.	Description	Part No.	Description
126-10	Input Spindle	139-18	Output Spindle	177-*	Key (See serial number on neck of KRA-5 above)
127-12	Retaining Screw	149-6	Spindle Wrench		S/N 15240 & lower use 177-7 square key.
127-13	Retaining Screw	150-1	3/16 Socket Key		S/N 15241 & higher use 177-11 Woodruff Key
129-27	Ball Bearing	150-2	1/8 Socket Key	178-2	Socket Head Set Screw
129-28	Ball Bearing	150-5	5/16 Socket Key	181-2	Screw Plug
131-33	Mitre Gear	151-4	Housing		
131-55	Mitre Gear	154-20	Sleeve		
132-14	Shim	154-32	Sleeve		
133-14	Clamping Screw	154-21	Sleeve		
133-16	Spindle Bolt	170-25	Coupler		
138-7	Jam Nut	177-11	Woodruff Key		



KS-23 Saw Unit

Adjustment Instructions

Installing the KS-23H (268-9)

To install the KS-23H onto the KRA-5 (100-7), Loosen the 133-29 screw. Slide the KS-23H onto the KRA-5. Tighten the 133-29 screw.

Adjusting the Angle of the KS-23H

Loosen the 133-29 screw and rotate the KS-23H on the KRA-5 to the desired position, being careful to keep the saw blade in line with the vee sight of the saw guard. Tighten the 133-29 screw.

Adjusting the Depth of Cut

Loosen the set screw N5027. To increase the depth of cut turn the 133-13 clamping screw counter clockwise. To decrease the depth of cut turn the 133-13 clamping screw clockwise. Once the desired depth of cut is achieved, tighten the N5027 set screw. Ordinarily the saw blade should be extended approximately 1/16" to 1/8" more than the thickness of the material being cut. When cutting through a panel supported by ribs or other understructure that should be unmolested, extend the blade to the same distance as the measured thickness of the material being cut.

Replacing the Saw Blade

Insert the 149-6 open end spindle wrench behind the blade and span the flats on the 139-18 output spindle. Insert the 150-5 socket key into the hex socket of the 133-16 spindle bolt, loosen and remove both the bolt and the blade.

You will note the blade, which has a 7/16" bore, slips over the spindle and seats itself against the shoulder. This design provides for more concentricity resulting in smoother, faster and more accurate cutting. Slip the blade over the spindle, seat it against the shoulder, replace the spindle bolt